

NOTES:

- HATCH INDICATES BLOCKED FLOOR DIAPHRAGM AT SECOND FLOOR FRAMING.

1 S500
SHEAR WALL PLAN - FIRST FLOOR
 NO SCALE

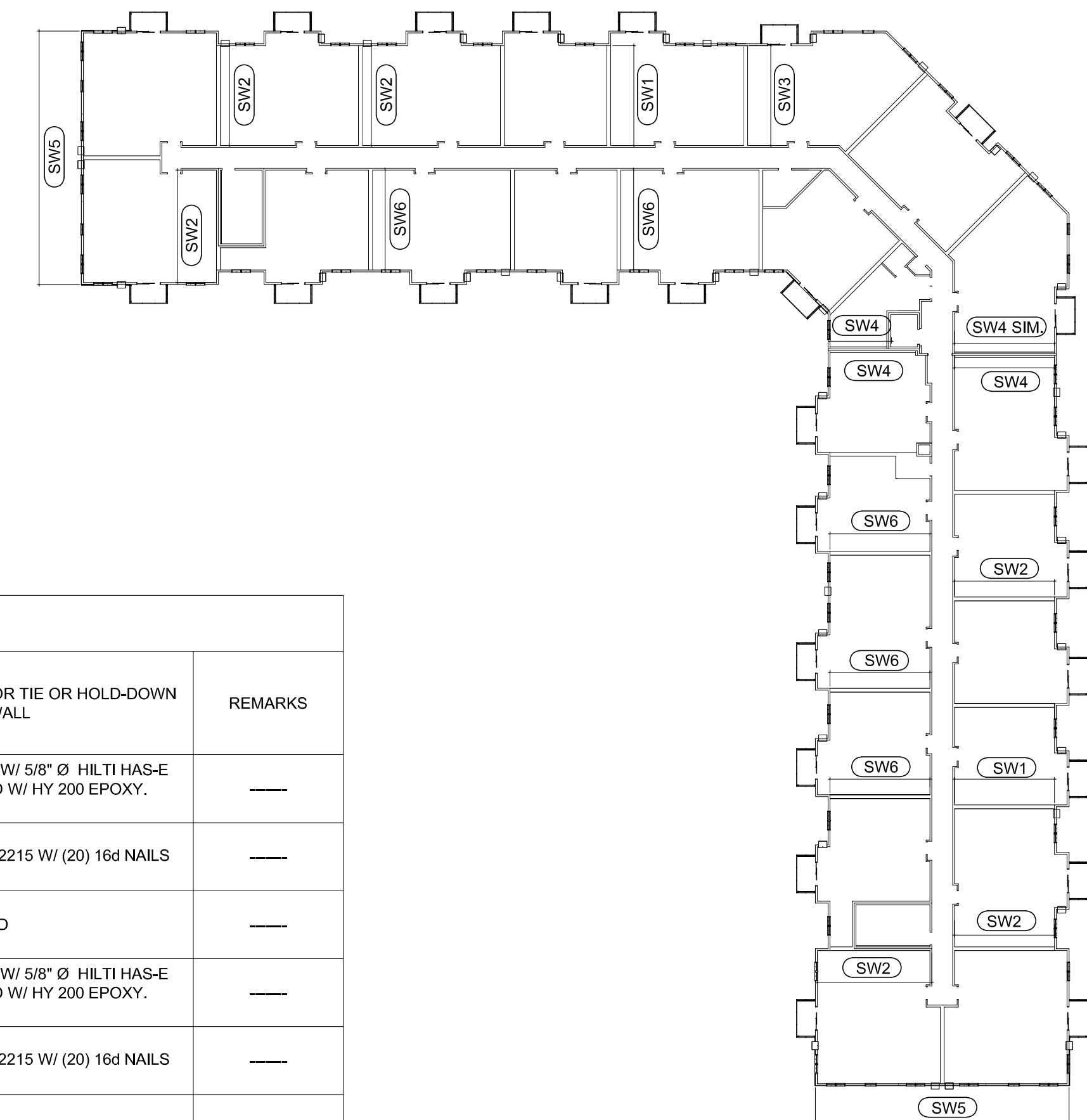

2 S500
SHEAR WALL PLAN - SECOND AND THIRD FLOOR
 NO SCALE

SHEAR WALL SCHEDULE								
MARK	FLOOR	SHEATHING	FASTENERS	MAX STUD SPACING	SILL PLATE FASTENERS BETWEEN HOLD-DOWNS	SHEAR WALL END POSTS	FLOOR TO FLOOR TIE OR HOLD-DOWN EACH END OF WALL	REMARKS
SW1	1ST	7/16" APA-RATED SHEATHING ONE FACE OF 2x6 WALL (BLOCKED)	PANEL EDGES: 8d NAILS @ 4" O.C. FIELD: 8d NAILS @ 12" O.C.	N/A	(2) HILTI X-C P.A.F. @ 16" O.C.	DOUBLE 2x6 (SEE NOTE 1)	SIMPSON HD3B W/ 5/8" Ø HILTI HAS-E THREADED ROD W/ HY 200 EPOXY. 6 1/2" EMBED	---
	2ND	7/16" APA-RATED SHEATHING ONE FACE OF 2x6 WALL (BLOCKED)	PANEL EDGES: 8d NAILS @ 6" O.C. FIELD: 8d NAILS @ 12" O.C.	N/A	(2) 20d NAILS @ 8" O.C.	DOUBLE 2x6 (SEE NOTE 1)	(2) SIMPSON ST2215 W/ (20) 16d NAILS	---
	3RD	5/8" GYP. BOARD ONE FACE OF 2x6 WALL (UNBLOCKED)	PANEL EDGES: 6d COOLER NAILS @ 7" O.C. FIELD: 6d COOLER NAILS @ 12" O.C.	24" O.C. (12" O.C IF STAGGERED)	(2) 20d NAILS @ 8" O.C.	DOUBLE 2x6 (SEE NOTE 1)	NONE REQUIRED	---
SW2	1ST	7/16" APA-RATED SHEATHING ONE FACE OF 2x6 WALL (BLOCKED)	PANEL EDGES: 8d NAILS @ 3" O.C. FIELD: 8d NAILS @ 12" O.C.	N/A	(2) HILTI X-C P.A.F. @ 12" O.C. MAX.	TRIPLE 2x6 (SEE NOTE 1)	SIMPSON HD5B W/ 5/8" Ø HILTI HAS-E THREADED ROD W/ HY 200 EPOXY. 10 1/2" EMBED	---
	2ND	7/16" APA-RATED SHEATHING ONE FACE OF 2x6 WALL (BLOCKED)	PANEL EDGES: 8d NAILS @ 4" O.C. FIELD: 8d NAILS @ 12" O.C.	N/A	(2) 20d NAILS @ 8" O.C.	DOUBLE 2x6 (SEE NOTE 1)	(2) SIMPSON ST2215 W/ (20) 16d NAILS	---
	3RD	5/8" GYP. BOARD ONE FACE OF 2x6 WALL (UNBLOCKED)	PANEL EDGES: 6d COOLER NAILS @ 7" O.C. FIELD: 6d COOLER NAILS @ 12" O.C.	24" O.C. (12" O.C IF STAGGERED)	(2) 20d NAILS @ 8" O.C.	DOUBLE 2x6 (SEE NOTE 1)	NONE REQUIRED	---
SW3	1ST	19/32" APA-RATED SHEATHING ONE FACE OF 2x6 WALL (BLOCKED)	PANEL EDGES: 10d NAILS @ 3" O.C. FIELD: 10d NAILS @ 12" O.C.	N/A	(2) HILTI X-C P.A.F. @ 8" O.C.	6x6 (SEE NOTE 2)	SIMPSON HD9B W/ 7/8" Ø HILTI HAS-E THREADED ROD W/ HY 200 EPOXY. 10 1/2" EMBED	---
	2ND	15/32" APA-RATED SHEATHING ONE FACE OF 2x6 WALL (BLOCKED)	PANEL EDGES: 8d NAILS @ 4" O.C. FIELD: 8d NAILS @ 12" O.C.	N/A	(2) 20d NAILS @ 6" O.C. MAX.	DOUBLE 2x6 (SEE NOTE 1)	(2) SIMPSON ST2215 W/ (20) 16d NAILS	---
	3RD	5/8" GYP. BOARD ONE FACE OF 2x6 WALL (BLOCKED)	PANEL EDGES: 6d COOLER NAILS @ 4" O.C. FIELD: 6d COOLER NAILS @ 12" O.C.	16" O.C. (8" O.C IF STAGGERED)	(2) 20d NAILS @ 6" O.C. MAX.	DOUBLE 2x6 (SEE NOTE 1)	(2) SIMPSON ST2215 W/ (20) 16d NAILS	---
SW4	1ST	7/16" APA-RATED SHEATHING ONE FACE OF EACH 2x6 WALL (BLOCKED)	PANEL EDGES: 8d NAILS @ 4" O.C. FIELD: 8d NAILS @ 12" O.C.	N/A	(2) HILTI X-C P.A.F. @ 16" O.C.	DOUBLE 2x6 ((4) - 2X4 @ SIM.) (SEE NOTE 1)	SIMPSON HD3B W/ 5/8" Ø HILTI HAS-E THREADED ROD W/ HY 200 EPOXY. 6 1/2" EMBED	---
	2ND	7/16" APA-RATED SHEATHING ONE FACE OF EACH 2x6 WALL (BLOCKED)	PANEL EDGES: 8d NAILS @ 6" O.C. FIELD: 8d NAILS @ 12" O.C.	N/A	(2) 20d NAILS @ 16" O.C.	DOUBLE 2x6 (DOUBLE 2X4 @ SIM.) (SEE NOTE 1)	(2) SIMPSON ST2215 W/ (20) 16d NAILS	---
	3RD	5/8" GYP. BOARD ONE FACE OF EACH 2x6 WALL (UNBLOCKED)	PANEL EDGES: 6d COOLER NAILS @ 7" O.C. FIELD: 6d COOLER NAILS @ 12" O.C.	24" O.C. (12" O.C IF STAGGERED)	(2) 20d NAILS @ 16" O.C.	DOUBLE 2x6 (DOUBLE 2X4 @ SIM.) (SEE NOTE 1)	NONE REQUIRED	---
SW5	1ST	7/16" APA-RATED SHEATHING ONE FACE OF 2x6 WALL (BLOCKED) W/ SIMPSON WSW 12x7	PANEL EDGES: 8d NAILS @ 6" O.C. FIELD: 8d NAILS @ 12" O.C.	N/A	SEE 6/S500 FOR WALL PORTIONS OUTSIDE OF GARAGE PORTALS	AT ENDS: DOUBLE 2x6 (SEE NOTE 1) AT EA. SIDE OF GARAGE DOORS; SIMPSON WSW12x7	AT ENDS: SIMPSON HD3B W/ 5/8" Ø HILTI HAS-E THREADED ROD W/ HY 200 EPOXY. 8 1/2" EMBED AT EA. SIDE OF GARAGE DOOR; SEE DETAILS 6/S501	SEE ELEV. 9/S501
	2ND	7/16" APA-RATED SHEATHING ONE FACE OF 2x6 WALL (UNBLOCKED)	PANEL EDGES: 8d NAILS @ 6" O.C. FIELD: 8d NAILS @ 12" O.C.	N/A	(2) 20d NAILS @ 16" O.C.	DOUBLE 2x6 (SEE NOTE 1)	(2) SIMPSON ST2215 W/ (20) 16d NAILS	---
	3RD	7/16" APA-RATED SHEATHING ONE FACE OF 2x6 WALL (UNBLOCKED)	PANEL EDGES: 8d NAILS @ 6" O.C. FIELD: 8d NAILS @ 12" O.C.	N/A	(2) 20d NAILS @ 16" O.C.	DOUBLE 2x6 (SEE NOTE 1)	(2) SIMPSON ST2215 W/ (20) 16d NAILS	---
SW6	1ST	---	---	---	---	DOUBLE 2x6 (SEE NOTE 1)	---	SEE NOTE 3
	2ND	7/16" APA-RATED SHEATHING ONE FACE OF 2x6 WALL (BLOCKED)	PANEL EDGES: 8d NAILS @ 4" O.C. FIELD: 8d NAILS @ 12" O.C.	N/A	(2) 20d NAILS @ 8" O.C.	DOUBLE 2x6 (SEE NOTE 1)	(2) SIMPSON ST2215 W/ (20) 16d NAILS	---
	3RD	5/8" GYP. BOARD ONE FACE OF 2x6 WALL (UNBLOCKED)	PANEL EDGES: 6d COOLER NAILS @ 7" O.C. FIELD: 6d COOLER NAILS @ 12" O.C.	24" O.C. (12" O.C IF STAGGERED)	(2) 20d NAILS @ 8" O.C.	DOUBLE 2x6 (SEE NOTE 1)	NONE REQUIRED	---
SW7	1ST	7/16" APA-RATED SHEATHING ONE FACE OF 2x6 WALL (BLOCKED)	PANEL EDGES: 8d NAILS @ 3" O.C. FIELD: 8d NAILS @ 12" O.C.	N/A	(2) HILTI X-C P.A.F. @ 16" O.C.	TRIPLE 2x6 (SEE NOTE 1)	SIMPSON HD5B W/ 5/8" Ø HILTI HAS-E THREADED ROD W/ HY 200 EPOXY. 10 1/2" EMBED	---

- SHEAR WALL SCHEDULE NOTES:
- NAIL STUDS TOGETHER WITH 16d NAILS @ 12" O.C. STAGGERED, FULL HEIGHT.
 - CONTRACTOR MAY SUBSTITUTE (4) 2x6 FOR 6x6 POST, NAILED PER NOTE #1.
 - PROVIDE A GIRDER TRUSS IN 2ND FLOOR UNDER 2x6 SHEARWALL. DESIGN G.T. TO SUPPORT POINT LOADS OF 3.26 KIPS UPLIFT AND 6.36 KIPS DOWN UNDER END POSTS, CENTERED 6" FROM END OF G.T. PROVIDE (2) 2x6 UNDER G.T.

NO.	REVISION/ISSUE	DATE
2	MECHANICAL REVISIONS	10/07/25
1	REVISIONS	07/23/25
	PERMIT SET	03/06/25

JOB TITLE:
PARK & 3rd LOFTS

ALEXANDRIA, MN

Registration Information :
 I hereby certify that this plan, specification or report was prepared by me or under my direct supervision and that I am a duly Licensed Engineer, under the laws of the State of Minnesota.

Signature: *[Signature]*
 Name: JOSHUA HERZOG
 Date: 07/23/25 Reg. No.: 42392

HERZOG ENGINEERING
 1334 81ST AVE NE
 SPRING LAKE PARK, MN 55432
 (612) 844-1234
 WWW.HERZOGENGINEERING.COM

SHEET CONTENTS:
 SHEAR WALL PLANS

PROJECT #: 251010
 DRWN. BY: CL
 CHKD. BY: JH
 SCALE: AS NOTED

SHEET #:
S500